

REVISION HISTORY				
EC NUMBER	DATE	DESC.	REV.	APPROVED
-	6/11/04	CREATED DWG.	X00	CJ
-	6/14/04	INITIAL PRELIM STAGE REVISION	V00	RF
-	6/15/04	CHG AMPERAGE, ADD CERTS	V01	RF

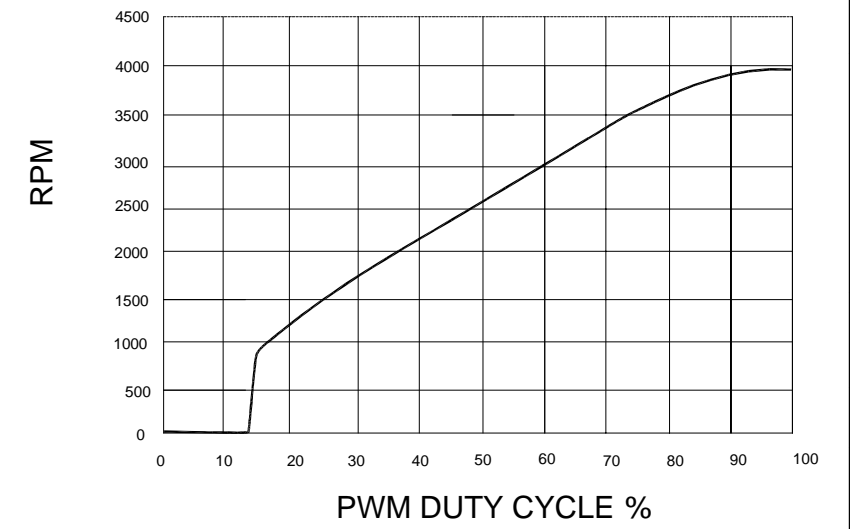

	ITEM	SPECIFICATION	UNITS/NOTES
MECHANICAL	SPEED	0 / 4000 ± 10%	RPM AT 12 VDC
	AIRFLOW	42	CFM IN FREE AIR
	STATIC PRESSURE	.24	INCHES H <sub>2</sub> O
	BEARING TYPE	BALL, DUAL	-
	OPERATING TEMP	-10 TO 70	°C
	STORAGE TEMP	-40 TO 70	°C
	NOISE LEVEL	41	dBA MAX AT 1M
PHYSICAL	L10 TEST DATA	75,000	HOURS
	BLADE MATERIAL	UL 94V-0	-
	FRAME MATERIAL	UL 94V-0	-
	WIRE SIZE	26	AWG
	WIRE TYPE	UL 1007	-
ELECTRICAL	REGULATORY APPROVALS	UL CUL TUV	-
	NET WEIGHT	73	GRAMS
	OPERATING VOLTAGE	6.0-13.8	VDC
	START UP PWM DUTY CYCLE	15	%
	RATED CURRENT	.23	AMP
	INPUT POWER	2.76	WATT
	TACH OUTPUT	2	PULSES/REV
MOTOR PROTECTION	POLARITY, AUTO RESTART	-	-

- NOTES:
- FAN LABEL MUST BE MARKED WITH DRAWING NUMBER TO AREA ON LABEL AS INDICATED USING SMALLEST LEGIBLE CHARACTER HEIGHT.
  - ALL DIMENSIONS ARE REFERENCE. REFER TO PLASTIC FRAME DRAWING FOR ALL MECHANICAL DIMENSIONS.
  - PWM CONTROL INPUT ELECTRICAL CHARACTERISTICS
    - INPUT IMPEDANCE GREATER THAN OR EQUAL TO 10K OHM
    - A LOGICAL HIGH ON PWM SIGNALS FAN FULL ON.
    - PWM OPERATING FREQUENCY IS 25 KHz±5 KHz
    - PWM SIGNAL INPUT IS TTL/CMOS COMPATIBLE.
      - MAXIMUM VOLTAGE (VIL MAX) IS 0.8 VDC
      - MINIMUM VOLTAGE (VIH MIN) IS 2.0 VDC

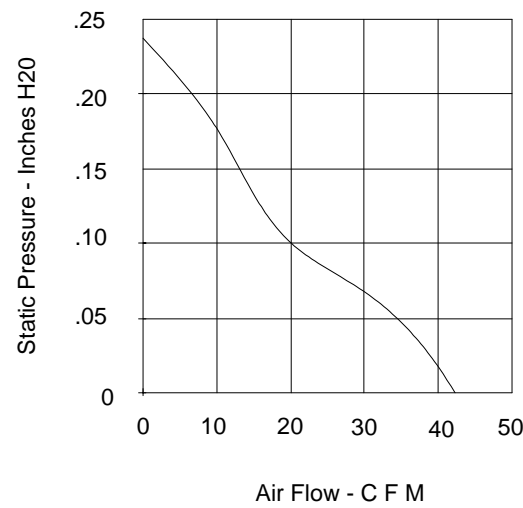
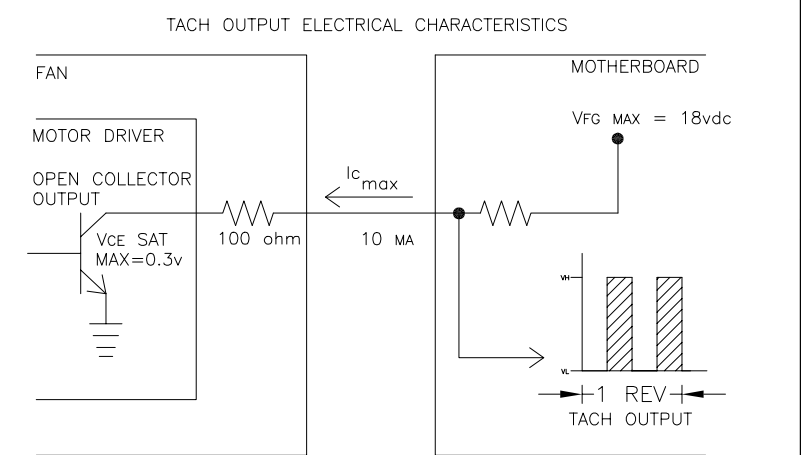
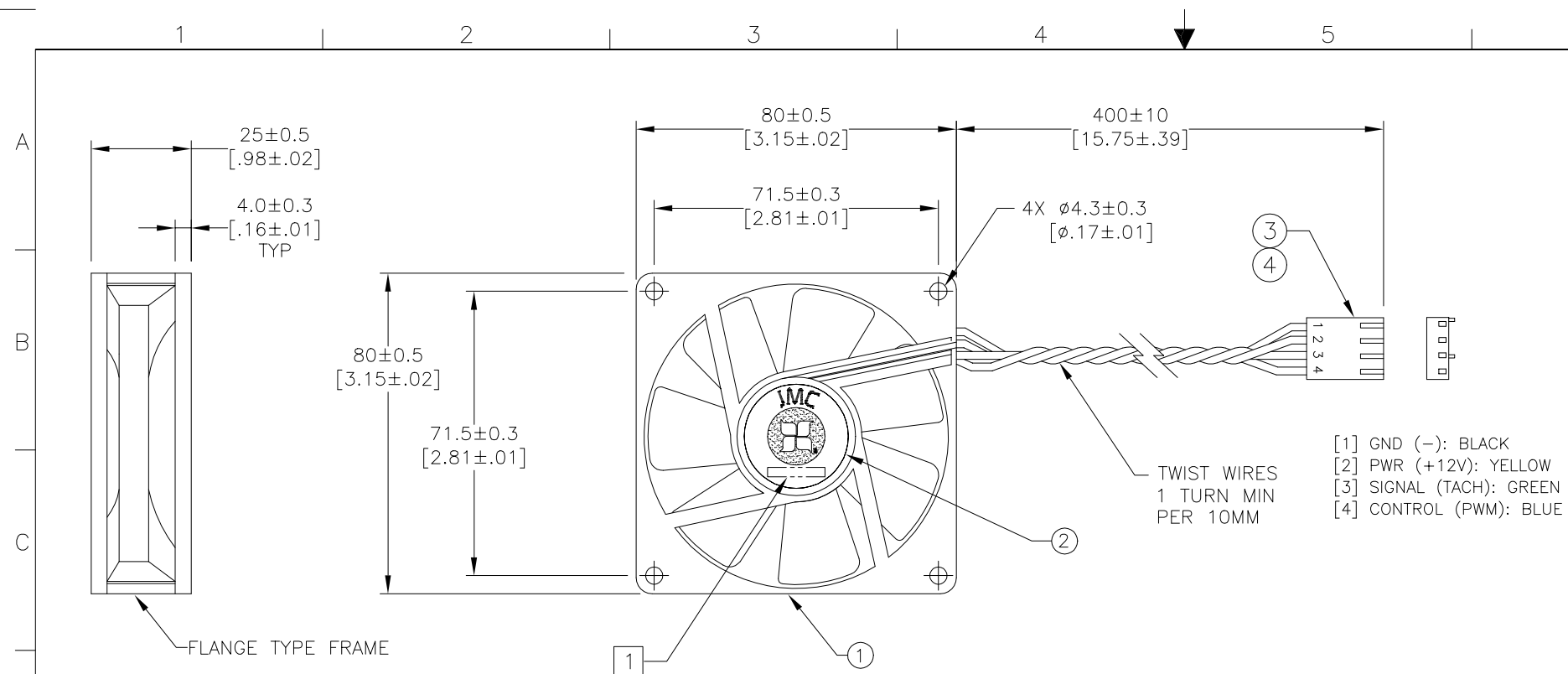
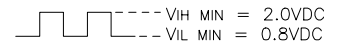

ITEM	QTY	DESCRIPTION	PART NUMBER	MANUFAC.
4	4	TERMINAL	2511-T1	WIESON
3	1	CRIMP TERMINAL HOUSING	2510C888-001	WIESON
2	1	LOGO LABEL	3081-2611-002	JMC
1	1	FAN MODEL	8025-12HB [APW]	JMC

PRIMARY UNITS IN MILLIMETERS  
ALTERNATE UNITS [ ] IN INCHES

TOLERANCE UNLESS OTHERWISE SPECIFIED  
X.X±0.3 [.01]  
X.XX±0.13 [.005]

THIRD ANGLE PROJECTION

**JMC** AUSTIN, TEXAS

TITLE: FAN, 80x25 MM, 12V, DC, HSPD, DBB, TACH, PWM, CONN, CSTM

DRAWN BY: R. FISHER DATE: 6/15/04  
ENGINEER: C. JANAK DATE: 6/15/04

SIZE: A2 DRAWING NO.: 812611PW-8 REV: V01  
SCALE: NONE SHEET: 1 OF 1

REV. V01  
DRAWING NO. 812611PW-8